

**vtech**<sup>®</sup>  
Baby

# User's Manual

## Little Friendlies Glow & Giggle Playmat



© 2016 VTech  
All rights reserved  
**Printed in China**  
91-003252-000 (M)

VTech understands that a child's needs and abilities change as they grow and with that in mind we develop our toys to teach and entertain at just the right level...

## Pre-School

Interactive toys to develop their imagination and encourage language development

## vtech Baby

Toys that will stimulate their interest in different textures, sounds and colours

### I am...

...responding to colours, sounds and textures

...understanding cause and effect

...learning to touch, reach, grasp, sit-up, crawl and toddle

### I want...

...to get ready for school by starting to learn the alphabet and counting

...my learning to be as fun, easy and exciting as can be

...to show my creativity with drawing and music so my whole brain develops

## Electronic Learning Computers

Cool, aspirational and inspiring computers for curriculum related learning

### I need...

...challenging activities that can keep pace with my growing mind

...intelligent technology that adapts to my level of learning

...National Curriculum based content to support what I'm learning at school

Birth-36 months

3-6 years

4-10 years



To learn more about this and other VTech® products, visit [www.vtech.co.uk](http://www.vtech.co.uk)

# INTRODUCTION

Thank you for purchasing the **VTech® Little Friendlies Glow & Giggle Playmat** learning toy!

The **VTech® Little Friendlies Glow & Giggle Playmat** is the perfect grow-with-me toy that transitions from a play gym to a tummy time playmat to an activity centre. The modes of play also grow and develop along with baby, starting out with basic music and progressing to teaching about colours, shapes and animals to asking simple questions that toddlers can answer with the chunky piano keys. With so much to do your child will surely get a workout in this learning gym!

ARCH

DANGLING  
ANIMALS

BABY-SAFE  
MIRROR  
PLAYMAT

TWO  
PULL TAGS

PIANO  
BUTTONS

DRUM  
BUTTON



INTRODUCTION

3

# INCLUDED IN THIS PACKAGE

- One instruction manual
- One playmat

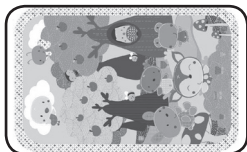

Two activity panel supports &  
two activity panel support bases



One arch



Two gym support legs



One **Little Friendlies Glow & Giggle Playmat** activity panel



One dangling  
baby-safe flower mirror



One dangling  
caterpillar teether



One dangling butterfly



- 18 screws



Four  
activity links

INCLUDED IN THIS PACKAGE

**WARNING:** All packing materials, such as tape, plastic sheets, packaging locks and tags are not part of this toy, and should be discarded for your child's safety.

**NOTE:** Please keep user's manual as it contains important information.

**Unlock the packaging locks:**

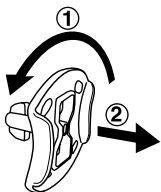

- ① Rotate the packaging locks 90 degrees anti-clockwise.
- ② Pull out the packaging locks.

## GETTING STARTED

### BATTERY INSTALLATION

1. Make sure the unit is turned **OFF**.
2. Locate the battery cover on the back of the activity panel. Use a screwdriver to loosen the screw.
3. Install 2 new AA (AM-3 / LR6) batteries following the diagram inside the battery box. (The use of new alkaline batteries is recommended for maximum performance).
4. Replace the battery cover and tighten the screw to secure.

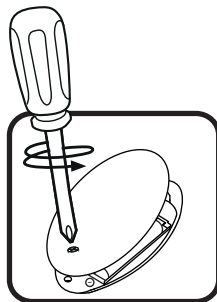



## BATTERY NOTICE

- Use new alkaline batteries or fully charged NI-MH (Nickel Metal-hydride) rechargeable batteries for best performance.
- Use only batteries of the same or equivalent type as recommended.
- Do not mix different types of batteries: alkaline, standard (carbon-zinc) or rechargeable (Ni-Cd, Ni-MH), or new and used batteries.
- Do not use damaged batteries.
- Insert batteries with the correct polarity.
- Do not short-circuit the battery terminals.
- Remove exhausted batteries from the toy.
- Remove batteries during long periods of non-use.
- Do not dispose of batteries in fire.
- Do not charge non-rechargeable batteries.
- Remove rechargeable batteries from the toy before charging (if removable).
- Rechargeable batteries are only to be charged under adult supervision.

### Disposal of batteries and product



The crossed-out wheellie bin symbols on products and batteries, or on their respective packaging, indicates they must not be disposed of in domestic waste as they contain substances that can be damaging to the environment and human health.



The chemical symbols Hg, Cd or Pb, where marked, indicate that the battery contains more than the specified value of mercury (Hg), cadmium (Cd) or lead (Pb) set out in Battery Directive (2006/66/EC).

The solid bar indicates that the product was placed on the market after 13th August, 2005.

Help protect the environment by disposing of your product or batteries responsibly.

For more information, please visit:

[www.recycle-more.co.uk](http://www.recycle-more.co.uk)

[www.recyclenow.com](http://www.recyclenow.com)

GETTING STARTED

# ASSEMBLY INSTRUCTIONS

With the **VTech® Little Friendlies Glow & Giggle Playmat**, safety comes first. To ensure your child's safety, adult assembly is required.

**WARNING!** This unit contains 18 screws (small part). For your child's safety, do not let your child play with the toy until it is fully assembled.

1. Attach the two activity panel support posts to the top of the two activity panel support bases. Use four screws to attach each post to the base and tighten them until secure.



2. Insert the two gym support legs to the two activity panel support bases. Use four screws to attach each of the legs to the activity panel support bases, tightening them until secure.

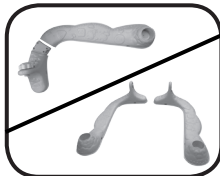

3. Insert the activity panel between the two activity panel support posts. Use the two plastic screws to attach the activity panel to the activity panel support posts. Adjust the position of the activity panel as you see fit. The activity panel can be attached in three different positions to suit baby's needs.

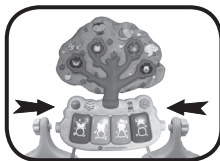

ASSEMBLY INSTRUCTIONS



4. Insert the gym arch to the two support legs until you hear them click into place. Make sure the arch is securely attached to the base. Once the arch is assembled, it cannot be disassembled.
5. To adjust the angle of the tree slide the two purple tabs on the back of the activity panel and adjust the tree to suit baby's needs.
6. Attach the dangling animal characters and the mirror to the arch, threading the activity links through the loops on the arch.
7. To secure the playmat to the gym support legs, thread the 6 fabric tags on the playmat through the slots on the gym support legs and the activity panel. Make sure the playmat is securely attached to the support legs.

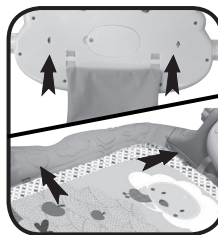
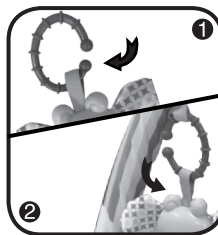
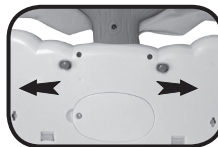
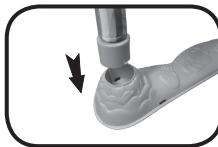

## ASSEMBLY INSTRUCTIONS





## PRODUCT FEATURES

### 1. ON/OFF/MODE SELECTOR SWITCH

To turn the unit **ON**, slide the **ON/OFF/MODE SELECTOR SWITCH** to the **MUSIC MODE** (🎵), **ANIMAL MODE** (🐾) or the **COLOURS & SHAPES MODE** (🎨). To turn the unit **OFF**, slide the **ON/OFF/MODE SELECTOR SWITCH** to the **OFF** (●) position.

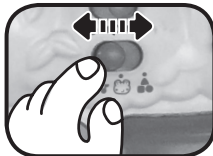

### 2. VOLUME CONTROL SWITCH

To adjust the volume, slide the **VOLUME CONTROL SWITCH** to the **LOW VOLUME** (🔊) or **HIGH VOLUME** (🔊) position.

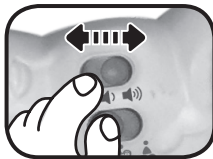

### 3. AUTOMATIC SHUT-OFF

To preserve battery life, the **VTech® Little Friendlies Glow & Giggle Playmat** will automatically power-down after approximately 30 seconds without input. The unit can be turned on again by pressing any button or pulling on the pull tags.

**Note:** If the unit repeatedly powers down or the unit will not turn on, we suggest changing the batteries.

## ACTIVITIES

1. Slide the **ON/OFF/MODE SELECTOR SWITCH** to turn the unit on. You will hear a song and a welcoming phrase in the Music Mode and the Animal Mode. In the Colours & Shapes Mode you will hear a sound, a phrase and a short tune. The lights will flash with the sounds.

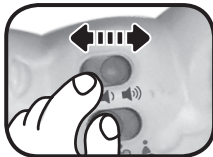



2. Press the **PIANO BUTTONS** to hear piano notes in the Music Mode, learn about animals, colours and shapes in the Animal Mode and hear fun sing-along songs, phrases and short tunes in the Colours & Shapes Mode. The lights will flash with the sounds.



3. Press the **DRUM BUTTON** to hear drum sounds in the Music Mode and the Animal Mode. In the Colours & Shapes Mode you will be asked to answer simple questions. The lights will flash with the sounds.



4. Pull the **LEAF TAGS** to hear a variety of melodies in the Music Mode, short tunes and sounds in the Animal Mode and short tunes in the Colours & Shapes Mode. The lights will flash with the sounds.

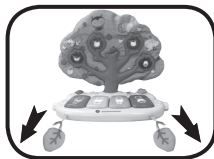

## MELODY LIST

1. Clementine
2. Animal Fair
3. Alouette
4. Aiken Drum
5. Alphabet Song
6. Shoo Fly
7. Bicycle Built for Two
8. Bingo
9. Did You Ever See a Lassie?



10. Farmer in the Dell
11. Froggie Went a Courtin'
12. Hickory Dickory Dock
13. Humpty Dumpty
14. Little Miss Muffet
15. Pop! Goes the Weasel
16. Where Has My Little Dog Gone?
17. Old MacDonald
18. This Old Man
19. Three Blind Mice
20. Yankee Doodle

## SING-ALONG SONG LYRICS

### SONG 1

Crawl under your tree,  
What do you see?  
Some bugs and a bee,  
And lights all twinkle-ee

### SONG 2

We went to the animal fair,  
The owl and fox were there,  
The frog sat in the clear blue pond.  
And the bunny was bouncing around.

### SONG 3

Splish, splash! Ribbit-ribbit!  
The frog likes splashing in the pond.

### SONG 4

The happy fox likes to play at night,  
When there is little light.



## SONG 5

Hip and hop, up and down,  
The bunny likes to hop around.

## SONG 6

The wise owl is perched up high,  
Looking at the stars in the sky.

# CARE & MAINTENANCE

1. Keep the unit clean by wiping it with a slightly damp cloth.
2. Keep the unit out of direct sunlight and away from any direct heat source.
3. Remove the batteries when the unit will not be in use for an extended period of time.
4. Do not drop the unit on hard surfaces and do not expose the unit to moisture or water.
5. The tree, arch and the butterfly are surface washable only.  
The playmat is machine washable. Follow the care instructions below.

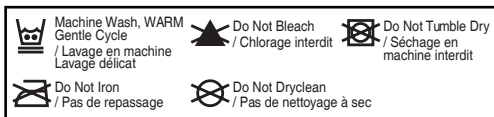

# TROUBLESHOOTING

If for some reason the program/activity stops working or malfunctions, please follow these steps:

1. Please turn the unit **OFF**.
2. Interrupt the power supply by removing the batteries.
3. Let the unit stand for a few minutes, then replace the batteries.
4. Turn the unit **ON**. The unit should now be ready to play again.



5. If the product still does not work, replace with an entire set of new batteries.

If the problem persists, please call our Consumer Services Department on 01235 546810 (from UK) or +44 1235 546810 (outside UK) and a service representative will be happy to help you.

**IMPORTANT NOTE:**

Creating and developing **VTech®** products is accompanied by a responsibility that we take very seriously. We make every effort to ensure the accuracy of the information which forms the value of our products. However, errors sometimes can occur. It is important for you to know that we stand behind our products and encourage you to call our Consumer Services Department on 01235 546810 (from UK) or +44 1235 546810 (outside UK) with any problems and/or suggestions that you might have. A service representative will be happy to help you.



**CLASS 1  
LED PRODUCT**

**WARNING:**  
Adult assembly required.





## PRODUCT REGISTRATION

Visit [www.vtech.co.uk/clubvtech/login](http://www.vtech.co.uk/clubvtech/login)  
to register your VTech product

By joining the VTech Club you can also enter competitions, find out about news and events, seek expert advice for parents and let your kids play fun learning games and activities.



## PRODUCT WARRANTY

Thank you for choosing this quality product from VTech. We hope it will bring many hours of entertainment, imaginative play and learning.

1. The product detailed above is covered by a one year warranty from the date of purchase, against any defects in materials or workmanship.
2. The product may be returned to the place of purchase. Alternatively the product can be returned to VTech Electronics Europe plc (see address below), with proof of purchase, without proof of purchase no replacement will be provided.
3. VTech Electronics Europe plc will examine the product and if it is found to be defective due to faulty materials or workmanship, will replace the product at their discretion.
4. If the product covered by this warranty is damaged due to misuse, modification or unauthorised repair, or because of faulty batteries, battery discharge or incorrect electrical connections, then this warranty becomes void.
5. This warranty is personal to the original purchaser and is not transferable.
6. Breakages to the LCD screen are not covered by the warranty.
7. Returns to VTech Electronics Europe plc should include a cheque or postal order for £1.50 towards the cost of return postage and packaging.
8. Products returned to VTech Electronics Europe plc, should be addressed as follows and packed carefully to avoid damage in transit (Please do not include batteries or adaptor). Please include details of the fault together with your name and address.
9. To keep an online record of your warranty, please register your product online at [www.vtech.co.uk/warranty](http://www.vtech.co.uk/warranty)

VTech Electronics EU PLC, c/o XPO Logistics, Warehouse 350, Cat & Fiddle Lane, West Hallam, DE7 6HE

THIS WARRANTY IS OFFERED AS AN EXTRA BENEFIT AND DOES NOT AFFECT CONSUMERS' STATUTORY RIGHTS.

This warranty is valid for the UK and Eire only. For products purchased outside the UK and Eire, please contact your local distributor or place of purchase.

91-003252-000 (EN)